



# APPLICATION MANUAL

## PRECAUTIONS:

- Make sure the vehicle has been prepped, washed, and decontaminated.
- For best results, paint correct the vehicle.
- Check the humidity and the temperature of both the surface & surrounding area. (60°F +).
- Do not apply the coating in direct sunlight, on a hot surface or under a heat lamp.
- Test product on an inconspicuous area before applying.
- Work in a ventilated area, and use gloves.
- Keep away from children.
- Discard towel & suede applicator immediately after use.
- We recommend having Various light sources to ensure proper installation and reduce the risk of high spotting.



### STEP #1

Shake  
**TOURBILLON**  
Before Use.

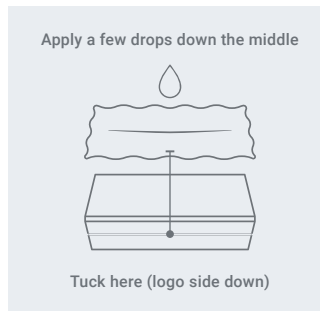

### STEP #2

Tuck a microfiber suede into the Fireball applicator block slits. Apply a few drops onto the suede applicator. Remember, a little goes a long way.

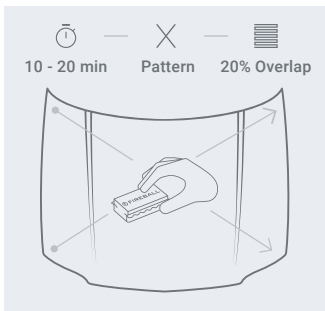

### STEP #3

Set a timer for 10 - 20 minutes. Apply coating in an "X" pattern, overlapping each line by 5%. If your layers are noticeably thin or do not remain visible, carefully add more coating.

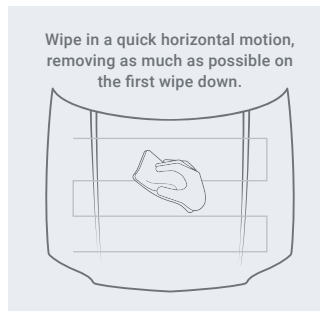

### STEP #4

After the coating flashes, wipe off the panel with a clean microfiber towel. If the coating doesn't wipe off easily, make a note to wipe off the excess sooner for your next application.

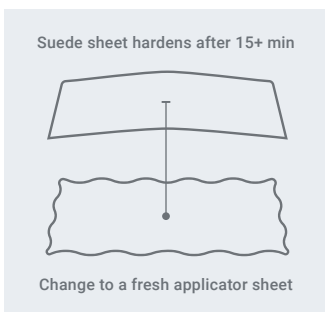

### STEP #5

Replace the applicator sheet every 15 minutes as the suede hardens. Apply a second coat 2 hours after the first, if needed.



### STEP #6

Keep out of the elements for 48 hrs.